

# 2.4Ghz Wireless RGB&Color temperature LED Downlight Instruction Manual [ 0192-1 ]

## 1. Introduction

Welcome to the Smart LED Lighting System. This manual describes the simple downlight which can work with RGBWW remote control, Please read the instruction manual carefully before using. Quick and Easy installation of the Smart downlight is the same as any other common downlight. The downlight can also be switched on at the wall for 2.4Ghz wireless operation, on/off, dim/brighten and color change. Secure communication is done by syncing the remote and downlight once.

## 2. Safety Guide

To reduce the risk of electric shock, please ensure the power is not connected when you install the downlight. Even though the light body is cold to touch shortly after normal operation, please be careful when handling the metal cooling fins as they may contain sharp edges. Always hold the light by the acrylic part. If the light is damaged, please seek professional electrical assistance, or please discard the light .

## 3. Installation

### 3.1 Battery Installation

•Please take the remote control and carefully press the battery cover and push it away in a downward motion. Install two AAA batteries as is shown in the picture, exactly match the negative (-) pole of each battery to the largest spring. Don't touch the color ring when you install the batteries. Place the battery cover back and install tightly.

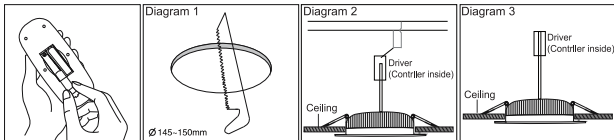

### 3.2 LED downlight Installation

- 1).This product is suitable for the ceiling-mounted installation.
- 2).Please open the hole on the ceiling according to the correct size of Diagram 1.
- 3).Connect the driver properly according to the wire connection Diagram 2. and then put the driver and wire into the ceiling from the hole.
- 4).Push in the two spring elements, make sure that they are deployed and anchored on the back of the ceiling.

Notice: Amateurs do not disassemble or install the lamps.

·Lamp installation must be correct and strict, solid and reliable, avoid long time using in violent vibration place.

·The lamps send out normal quantity of heat during working. Please don't use any cover to cover the body of the lamps.

### 4. Link/Unlink Downlight with Remote Control

Link: First power off, then power on, within 3 seconds touch any of the Zone-ON button of the remote 3 times shortly, the link is done when you see the light blinks 3 times with green color, otherwise try again later.

Unlink: First power off, then power on, within 3 seconds touch the linked Zone-ON button of the remote or the Master-ON button 5 times shortly, the unlink is done when you see the light blinks 10 times with red color, otherwise try again later.

### 5. Technical Parameters

Model No.	FUT066	Lifespan	50000 Hours
Power	12W	Beam Angle	120°
Color Temperature	2700K-6500K	PF	0.6
CRI	> 80	White LED	2835 (0.5W)
Light Efficiency	88LM/W	White LED QTY	Warm White LED 24pcs/Cold White LED 24pcs
Voltage	AC86-265V 50/60Hz	RGB LED	5050 (0.2W)
Size	Φ180*40mm	RGB LED QTY	20pcs
Hole Size	145-150mm	Material	Aluminum